

Solid handwheels with graduation ring and fold-away handle



- Material**
 High-resistance reinforced phenolic based (PF) Duroplast. Resistant to solvents, oils, greases and other chemical agents.
- Colour**
 Black, glossy finish.
- Ring**
 Matte anodised aluminium (ELESA original design).
- Graduation ring**
 Matte anodised aluminium with black marks and numbers. Left-hand graduation (it increases as handwheel is turned clockwise) with 0, 10, 20... 90 numbering (100 dividing marks).
- Standard execution**
 Black-oxide steel hub, H7 reamed hole with keyway.
 Fold-away handle type IR.302 in phenolic based (PF) Duroplast, black colour, glossy finish.
- Hole for blocking the adjustment**
 Brass boss at a distance R from the centre: hole (f) can be threaded M6 and used to couple other blocking elements.

Accessories on request

Axial retaining washer type GN 184.

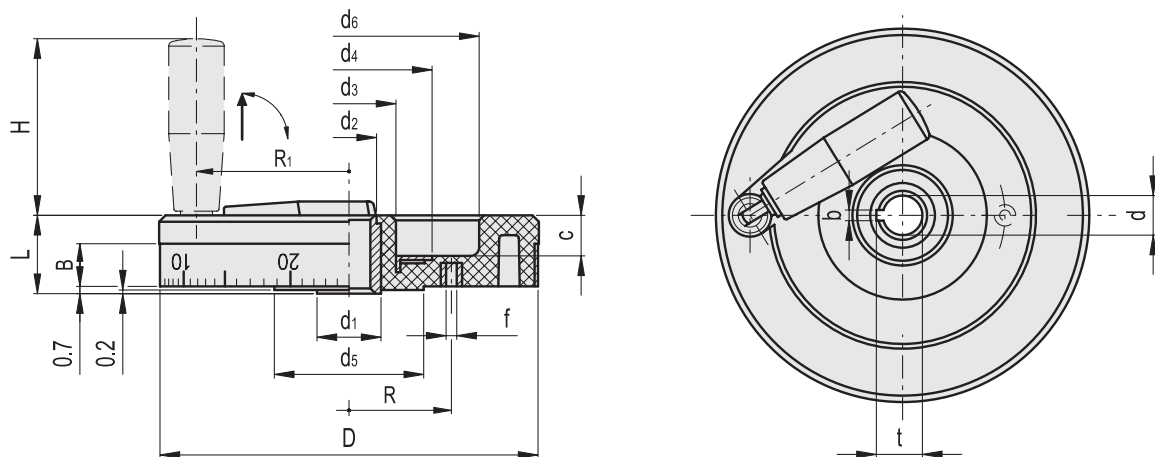

Code	Description	D	d _{H7}	t ^{+0.1}	b _{P9}	L	B	d ₁	d ₂	d ₃	d ₄	d ₅	d ₆	H	R	R ₁	c	f	⚖️
71701	VDG.175+IR A-20+GS-100/100	175	20	22.8	6	34	20	30	28	44	70	70	122	80	48	71	19	5	930
71751	VDG.200+IR A-20+GS-100/100	200	20	22.8	6	34	20	36	34	55	90	70	135	80	55	75	19	5	1185